

Duplication of this document and the use or communication of the contents thereof are forbidden without express authority. Offenders are punishable and liable to the payment of damages. All rights are reserved in the event of the grant of a patent or the registration of a utility model.

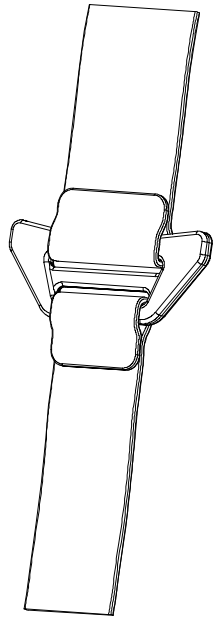

Assembly with Webbing

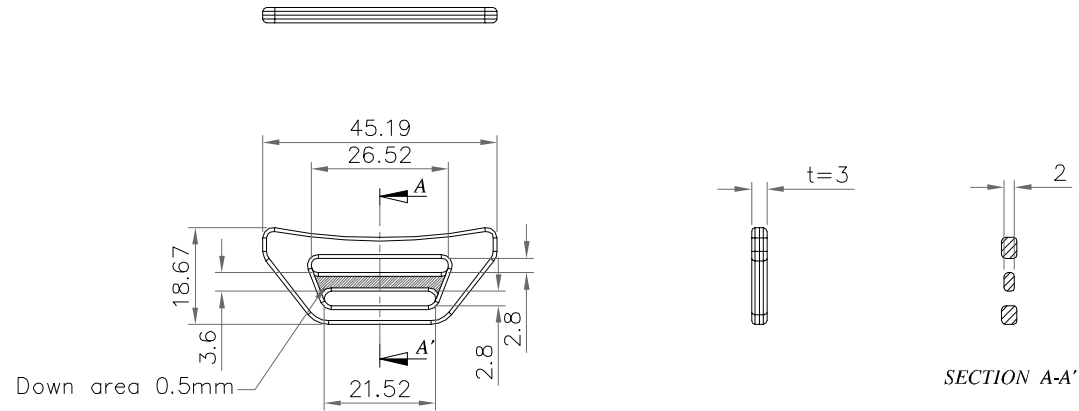

Down area 0.5mm

SECTION A-A'

REV.	Description	Engineer	Date

- NOTES -

1. Material : ALU6061-T6 T=3.0
2. Burr of bracket should be minimized(0.05mm)and bracket should be free of sharp edge.
3. Unspecified radius of bracket should be 0.7mm.
5. ** marked dimensions are important, need careful management.
6. Sample approval is required before manufacturing.
7. Confer with the person in chrage on the other matters.

STEP (mm)	Level 1	Level 2	Level 3	Date :	ITEM NAME: TOGGLE_SNOW
0-50	±0.1	±0.2	±0.3	Weight / g :	ITEM NO: TGOO7_TOGGLE Material: ALU6061-T6, T=3.0
51-100	±0.15	±0.3	±0.6	Size :	
101-200	±0.2	±0.4	±0.8	Color :	
201-above	±0.3	±0.6	±1.0	Scale :	
0-180°	±3°	±5°	±7°	Sheet:	Draw-by

KORE TECH
RELIABILITY IS OUR QUALITY

Approval by :